

FOUND RAILROAD SPIKE  
S. 1/4 CORNER SECTION 23  
T. 5 N. R. 45 E., BM  
INSTRUMENT # 85142

NEW HIGHWAY 33  
ELECTRICAL CROSSING

STATE HIGHWAY 33

20' LANDSCAPE BUFFER STRIP

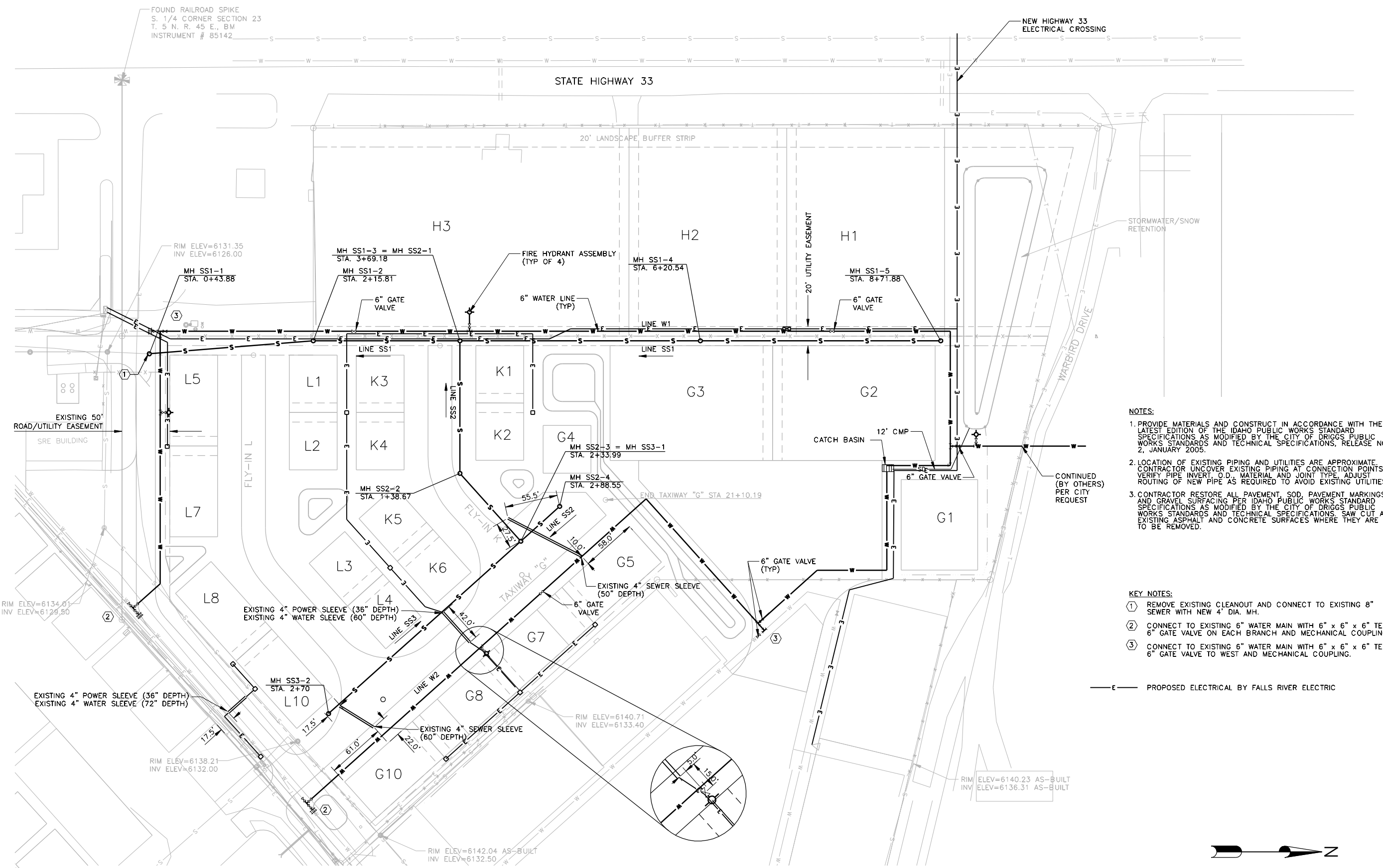

**NOTES:**

1. PROVIDE MATERIALS AND CONSTRUCT IN ACCORDANCE WITH THE LATEST EDITION OF THE IDAHO PUBLIC WORKS STANDARD SPECIFICATIONS AS MODIFIED BY THE CITY OF DRIGGS PUBLIC WORKS STANDARDS AND TECHNICAL SPECIFICATIONS, RELEASE NO. 2, JANUARY 2005.
2. LOCATION OF EXISTING PIPING AND UTILITIES ARE APPROXIMATE. CONTRACTOR UNCOVER EXISTING PIPING AT CONNECTION POINTS. VERIFY PIPE INVERT, O.D., MATERIAL AND JOINT TYPE. ADJUST ROUTING OF NEW PIPE AS REQUIRED TO AVOID EXISTING UTILITIES.
3. CONTRACTOR RESTORE ALL PAVEMENT, SOD, PAVEMENT MARKINGS AND GRAVEL SURFACING PER IDAHO PUBLIC WORKS STANDARD SPECIFICATIONS AS MODIFIED BY THE CITY OF DRIGGS PUBLIC WORKS STANDARDS AND TECHNICAL SPECIFICATIONS. SAW CUT ALL EXISTING ASPHALT AND CONCRETE SURFACES WHERE THEY ARE TO BE REMOVED.

**KEY NOTES:**

- ① REMOVE EXISTING CLEANOUT AND CONNECT TO EXISTING 8" SEWER WITH NEW 4' DIA. MH.
- ② CONNECT TO EXISTING 6" WATER MAIN WITH 6" x 6" x 6" TEE, 6" GATE VALVE ON EACH BRANCH AND MECHANICAL COUPLING.
- ③ CONNECT TO EXISTING 6" WATER MAIN WITH 6" x 6" x 6" TEE, 6" GATE VALVE TO WEST AND MECHANICAL COUPLING.

— E — PROPOSED ELECTRICAL BY FALLS RIVER ELECTRIC

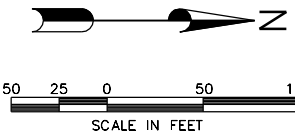

**DIAL BEFORE YOU DIG!!**  
CALL ONE CALL LOCATORS  
#1-800-342-1585

MANHOLE SCHEDULE	PIPELINE LOCATION	MANHOLE NO.	STATION	NORTHING	EASTING	MH RIM ELEV	MANHOLE NO.	PIPELINE LOCATION
	SS1	SS1-1	0+43.88	26800.05	29466.97	6131.35	SS1-1	SS1
	SS1	SS1-2	2+15.81	26971.44	29453.42	6131.99	SS1-2	SS1
	SS1	SS1-3 = SS2-1	3+69.18	27124.81	29453.42	6132.42	SS1-3 = SS2-1	SS1
	SS1	SS1-4	6+20.54	27376.16	29453.42	6134.56	SS1-4	SS1
	SS1	SS1-5	8+71.88	27627.52	29453.42	6134.37	SS1-5	SS1
	SS2	SS2-1 = SS1-3	0+00.00	27124.81	29453.42	6131.99	SS2-1 = SS1-3	SS2
	SS2	SS2-2	1+38.67	27124.81	29592.09	6134.18	SS2-2	SS2
	SS2	SS2-3 = SS3-1	2+33.99	27188.45	29663.04	6135.61	SS2-3 = SS3-1	SS2
	SS2	SS2-4	2+88.55	27229.07	29626.61	6135.26	SS2-4	SS2
	SS3	SS3-1 = SS2-3	0+00.00	27188.45	29663.04	6135.61	SS3-1 = SS2-3	SS3
	SS3	SS3-2	2+70.00	26987.46	29843.33	6137.73	SS3-2	SS3

412 E. Parkcenter Blvd., Suite 100  
BOISE, IDAHO 83706



NO.	DATE BY	DESCRIPTION
1	12/05	DRRAWINGS OF RECORD
2		
3		
4		
5		

DRIGGS FLY-IN PARKWAY  
DEVELOPMENT PROJECT

DESIGNED	CTC
DESIGN CHECKED	DJH
DETAILED	WAN
DRAWING CHECKED	CTC
FILE NAME	AB_PLAN.dgn
DRAWING DATE	JUNE 2005
DRAWING SCALE	AS SHOWN
SHEET	8 OF 10